

OVERVIEW OF THE WALL PANEL

PROJECTOR BASICS

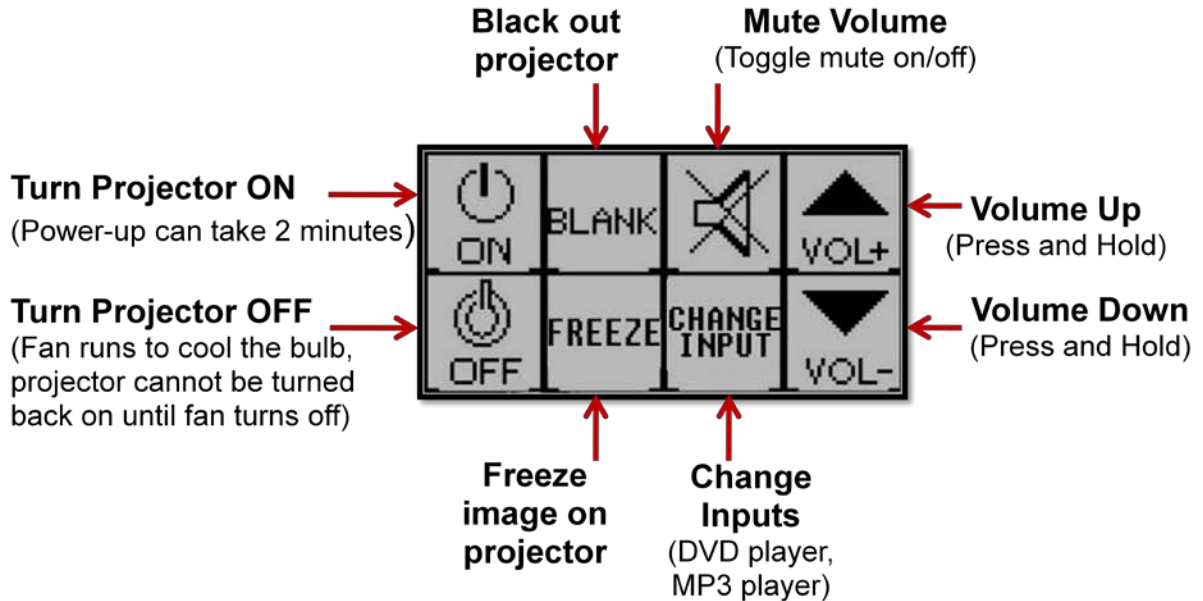

TO CHANGE THE INPUT

PROJECTOR BASICS

- 1** Turn Projector ON
- 2** To select a different input
- 3** Select desired input at Wall Panel:

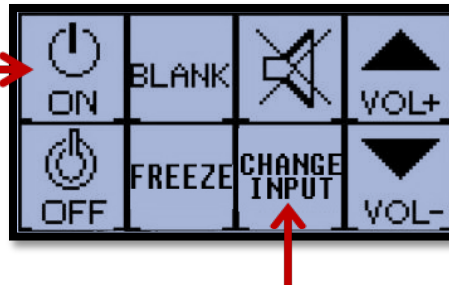

DVD/ VCR/ Video player

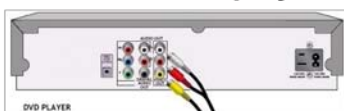

Wall Plate



Laptop/Computer



Wall Plate



MP3 player/ Audio player

Wall Plate

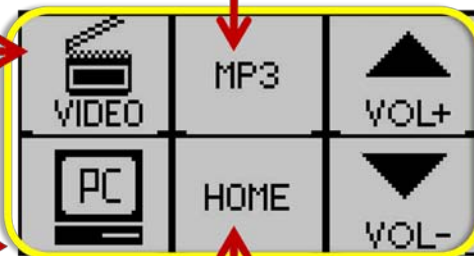

Back to Wall Panel Home



CONNECT A LAPTOP

Connecting Equipment

Connect the VGA cable to the Wall Plate and Computer



Connected correctly but still have no picture on your projector?

Press FN (Function) and F4. This will send the image out to the projector.



CONNECT AUDIO FROM LAPTOP

Connecting Equipment

Connect the audio cable into the audio port of computer...

Sometimes this port may have a picture of headphones 

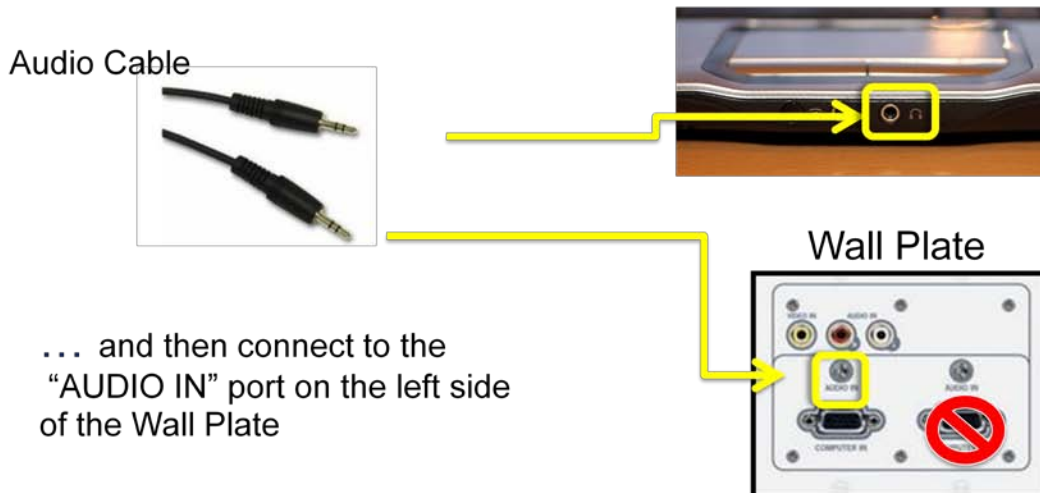

... and then connect to the "AUDIO IN" port on the left side of the Wall Plate

CONNECT AUDIO FROM MP3 PLAYER

Connecting Equipment

Connect the audio cable into the MP3 Player

Audio Cable



Plug into headphone port 

...and then connect to the "AUDIO IN" port on the right side of the Wall Plate.

Wall Plate



CONNECT DVD/VCR

Connecting Equipment

Connect the Composite Audio/Video Cable into the DVD/ VCR Player...

Composite Audio/Video Cable

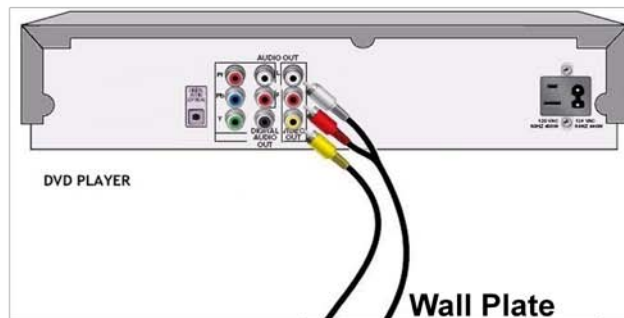

Wall Plate

...and then connect to the "VIDEO IN" & "AUDIO IN" port on the Wall Plate



CONNECT DOCUMENT CAMERA

Connecting Equipment

- 1** Connect the document camera to computer using the USB cable

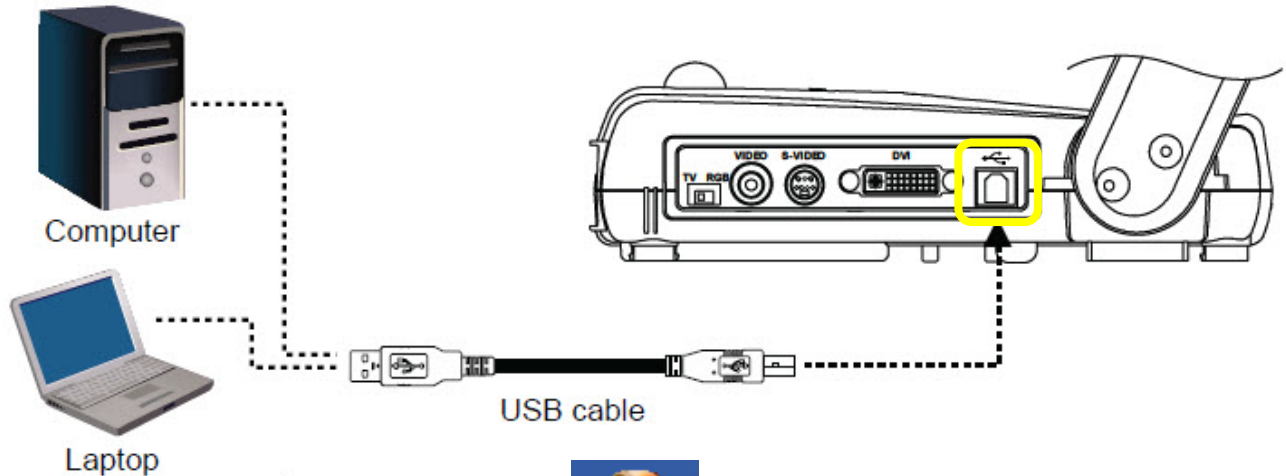

- 2** Open the AVerMedia software  [Start > Programs > AVerVision 3]

[Note: when document camera is connected with a usb cable, the computer must be connected to a projector.]

PROJECTOR SOFTWARE

Open the software: Double click the Projector Control icon on desktop



(This software works identically to the wall panel)

The screenshot shows the Projector Control software interface with the following annotated functions:

- Turn Projector ON** (Power-up can take 2 minutes) - points to the ON button.
- Turn Projector OFF** (Fan runs to cool the bulb, projector cannot be turned back on until fan turns off) - points to the OFF button.
- Black out projector** - points to the BLANK SCREEN button.
- Change Inputs** (DVD player, MP3 player) - points to the DVD / VIDEO and MP3 buttons.
- Freeze image on projector** - points to the FREEZE button.
- Mute Volume** (Toggle mute on/off) - points to the MUTE button.
- Volume Up** - points to the upward arrow button.
- Volume Down** - points to the downward arrow button.